

Load carrier*

Introduction

The specifications, constructional data and illustrations contained in this publication are not binding. We reserve the right to make modifications without prior notice.

Follow the instructions carefully when installing the load carriers.

Note

Read the safety instructions at the end of this manual.

Key number

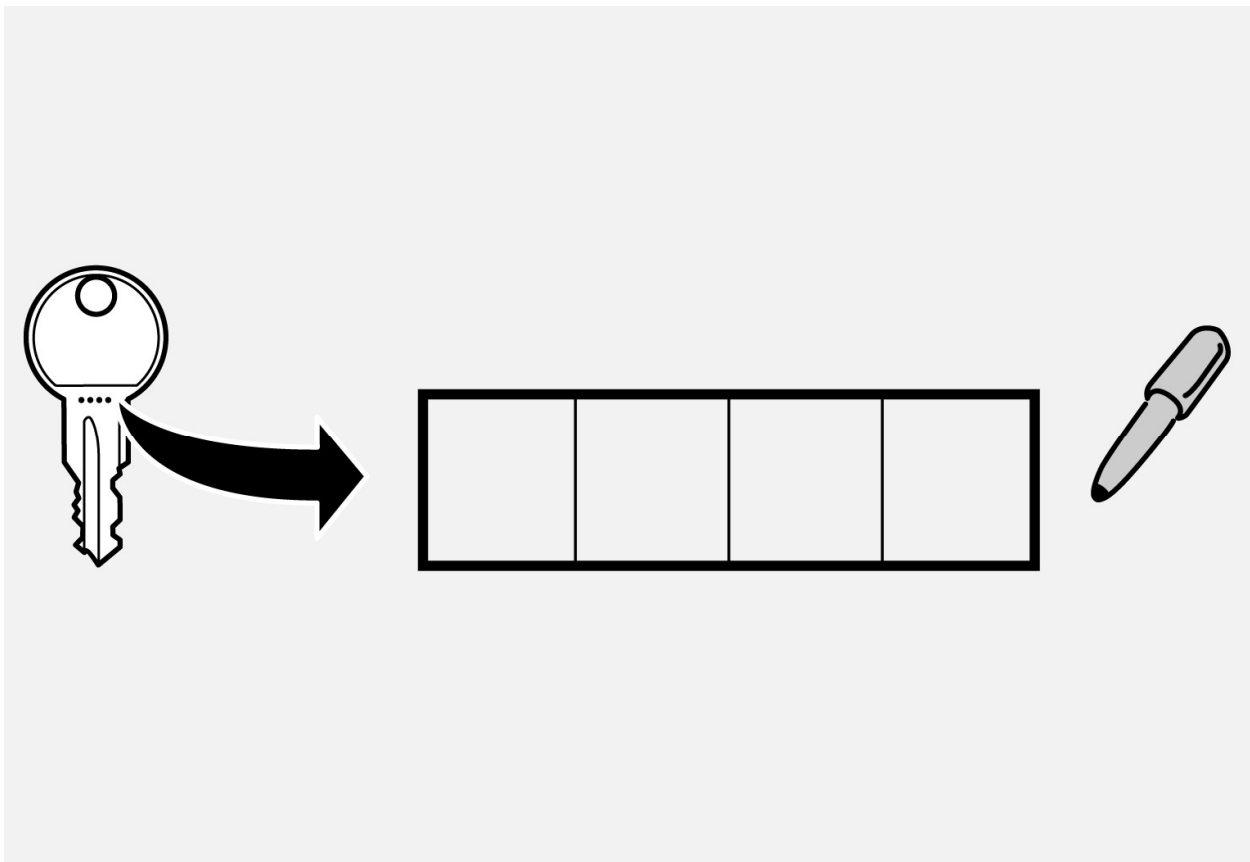

Please note down the number of your key in the box above. If the key is lost then it can be reordered.

Installing the load carriers

Kit contents



Preparations

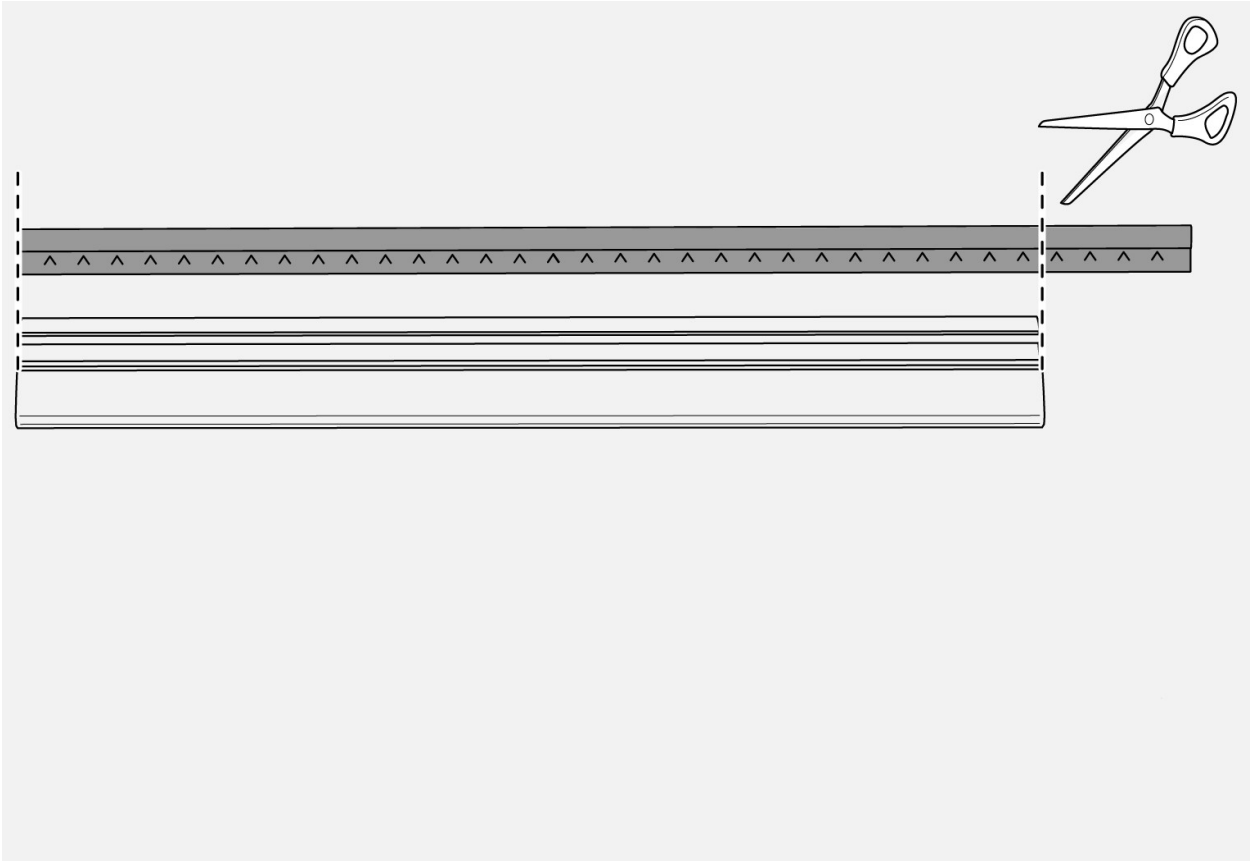

When installing for the first time, the trim needs to be cut to the correct length.

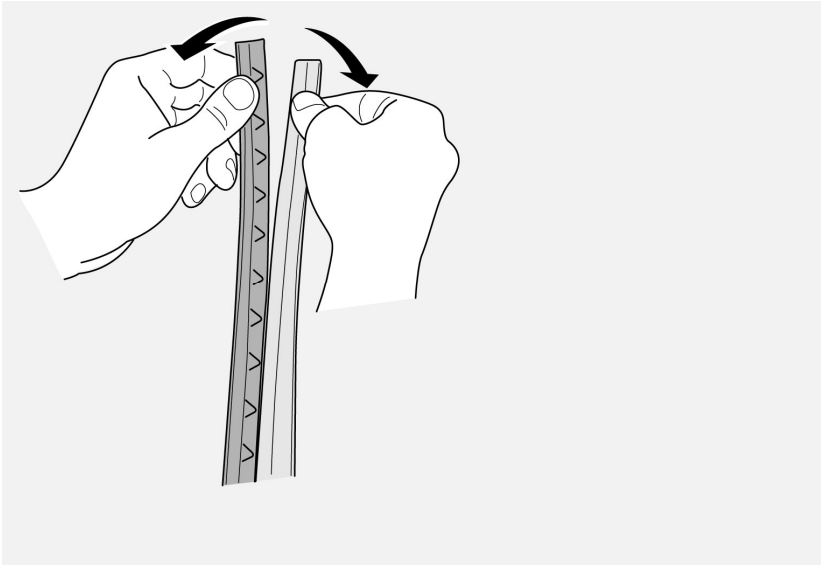

Then pull apart the T-track trim.

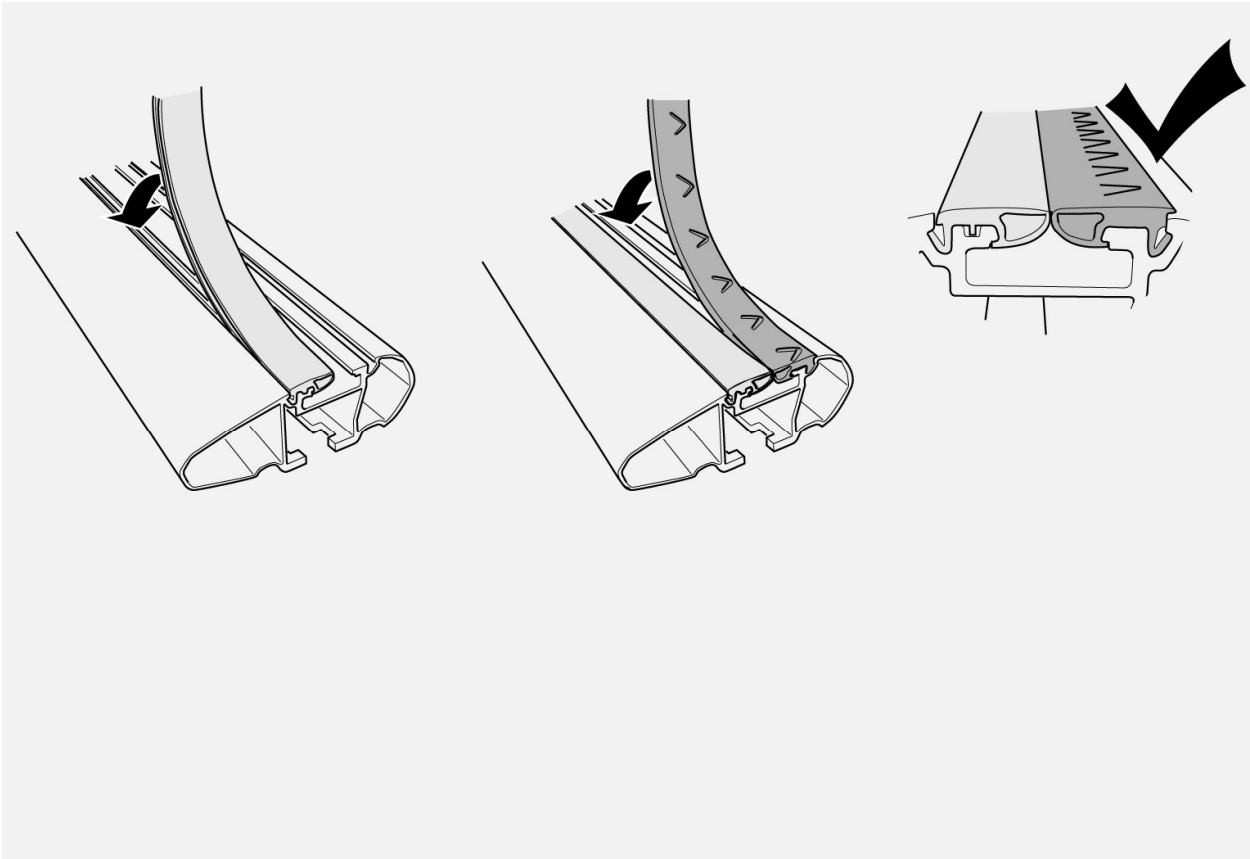

Apply the trim to the load carrier. The arrows on the trim show the installation direction. The arrows should point towards the front of the car.

Positioning the load carriers

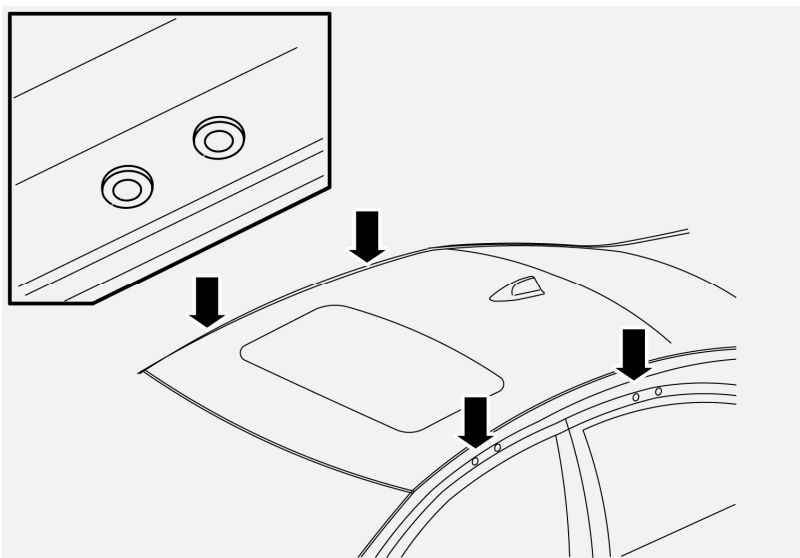

Open the doors.

Locate the mounting points for the load carriers in the door frames. The mounting points consist of two rivet nuts.

Note

To prevent paint damage: Thoroughly clean the rivet nuts and the roof where the attachment devices and feet for the load carriers will make contact.

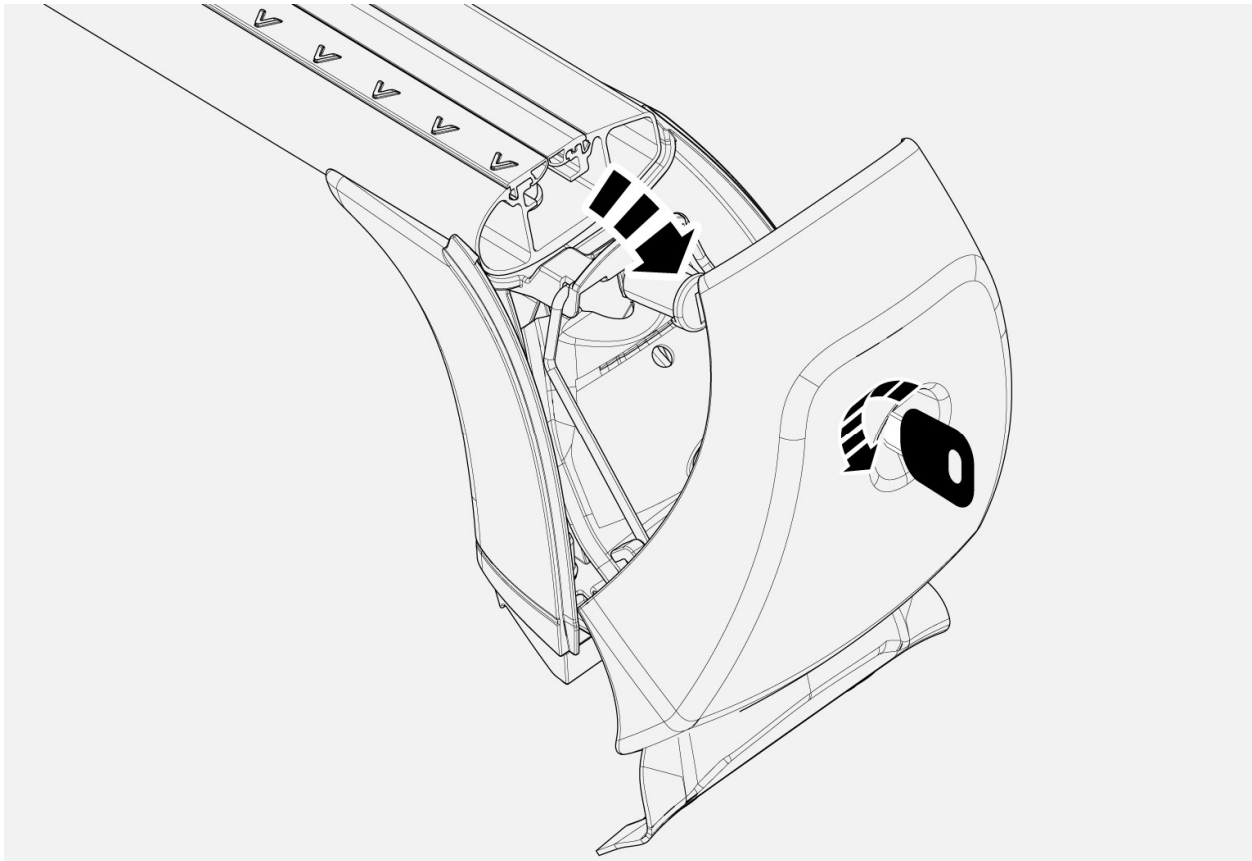

Loosen the covers on the load carriers by turning the locking key 90° anticlockwise, and then carefully loosen the cover.

Fold up the cover.

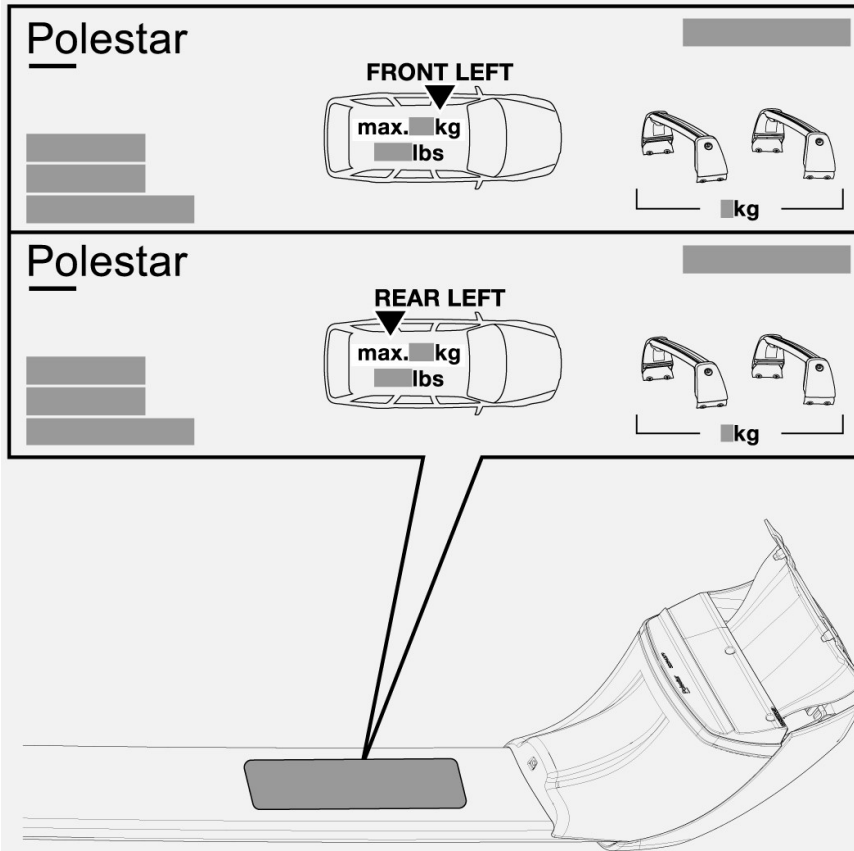

To install the right load carrier in the right place, see the decal located under the load carrier.

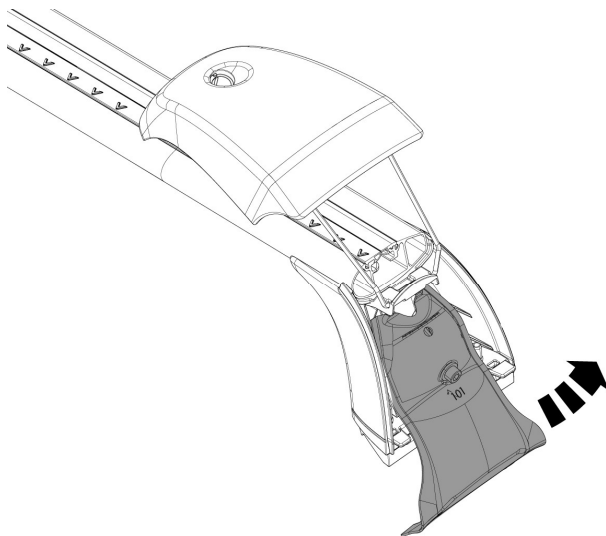

Undo the screw slightly on both sides of the load carrier's attaching brace. Pull the attaching brace out and fold it up.

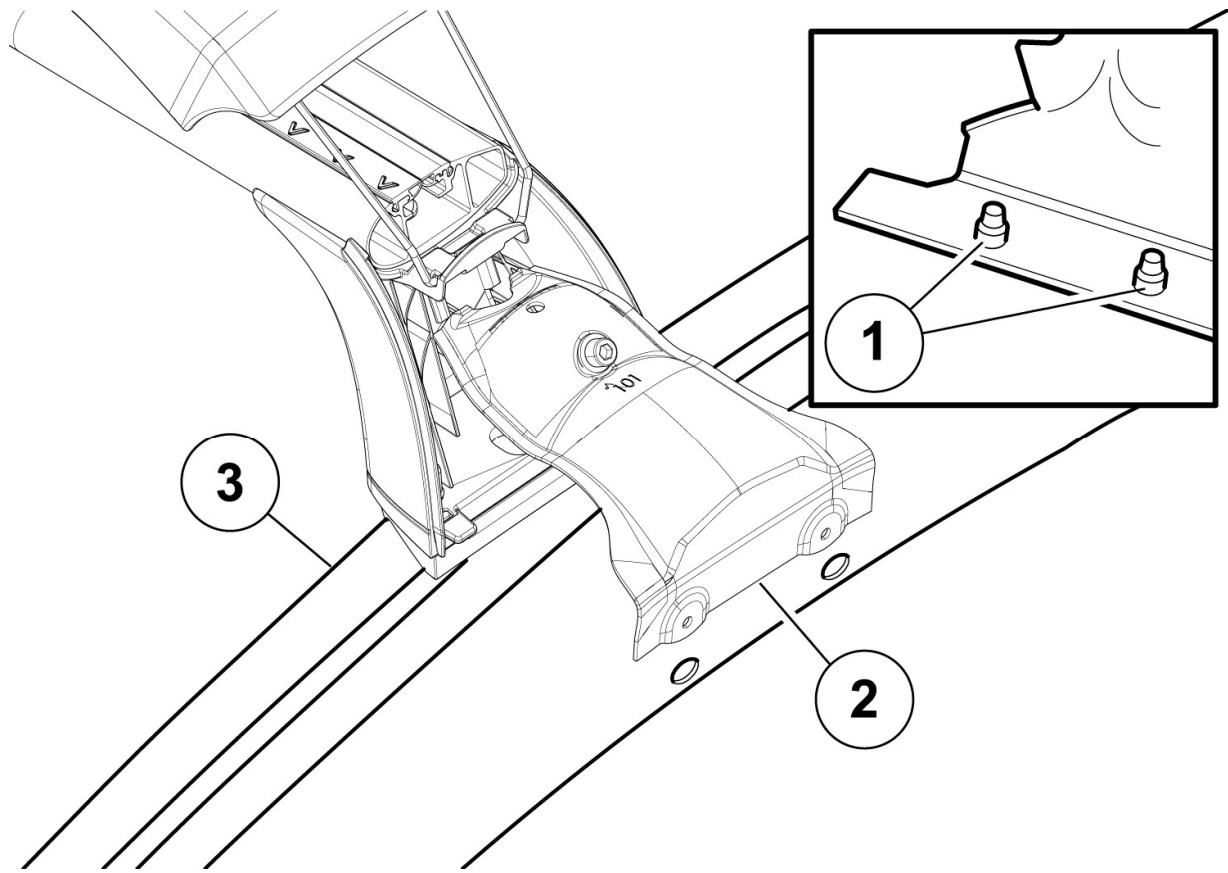

Position one of the load carrier's feet at the edge of the roof, so that the pins **1** on the attaching brace are in line with the rivet nuts **2** in the door frame.

Carefully lower the other load carrier foot to the edge of the roof on the other side.

Check that the small radius **3** on the load carrier's foot is in contact around the equivalent curvature on the top side of the roof edge.

Note

If the load carrier's foot is not in contact around the equivalent curvature on the top side of the roof edge, it is possible to loosen the screws under the rubber strip and adjust the foot several millimetres along the contour.

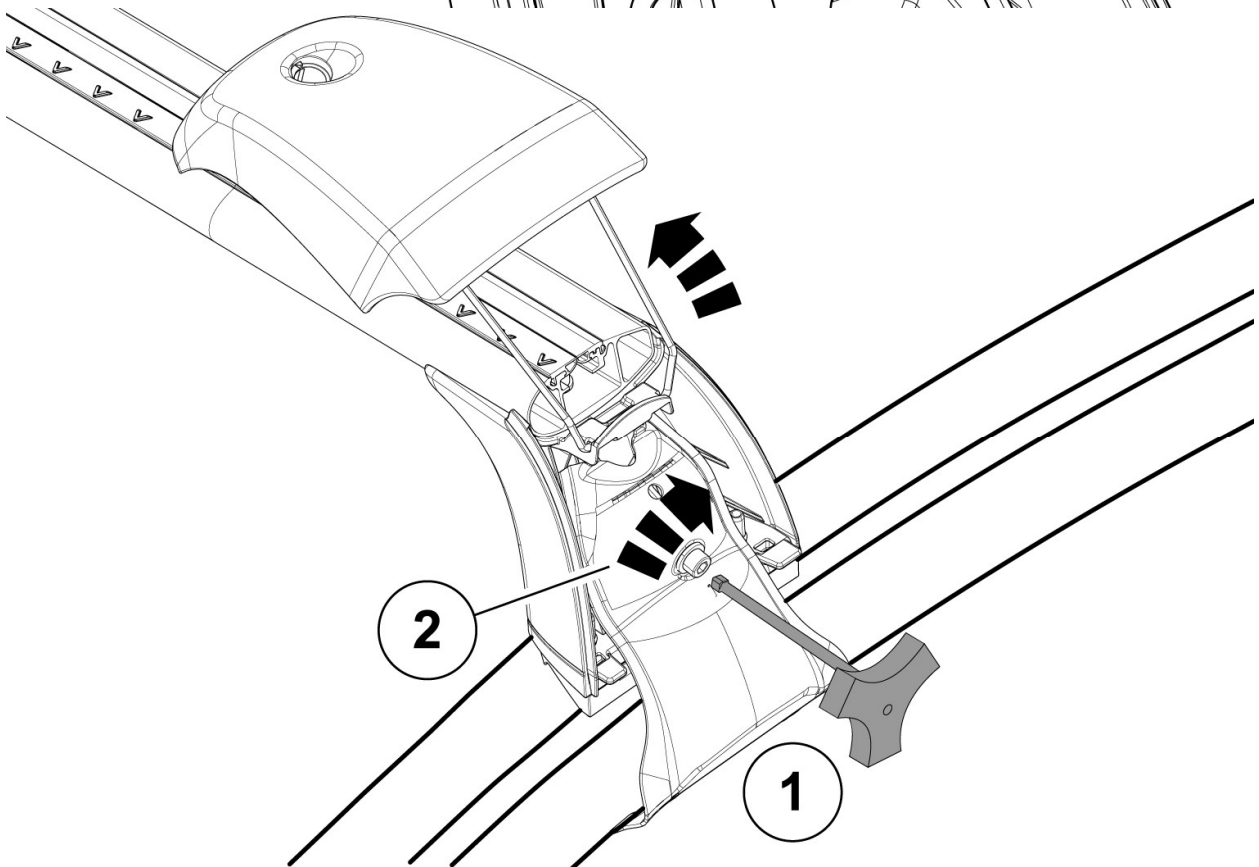
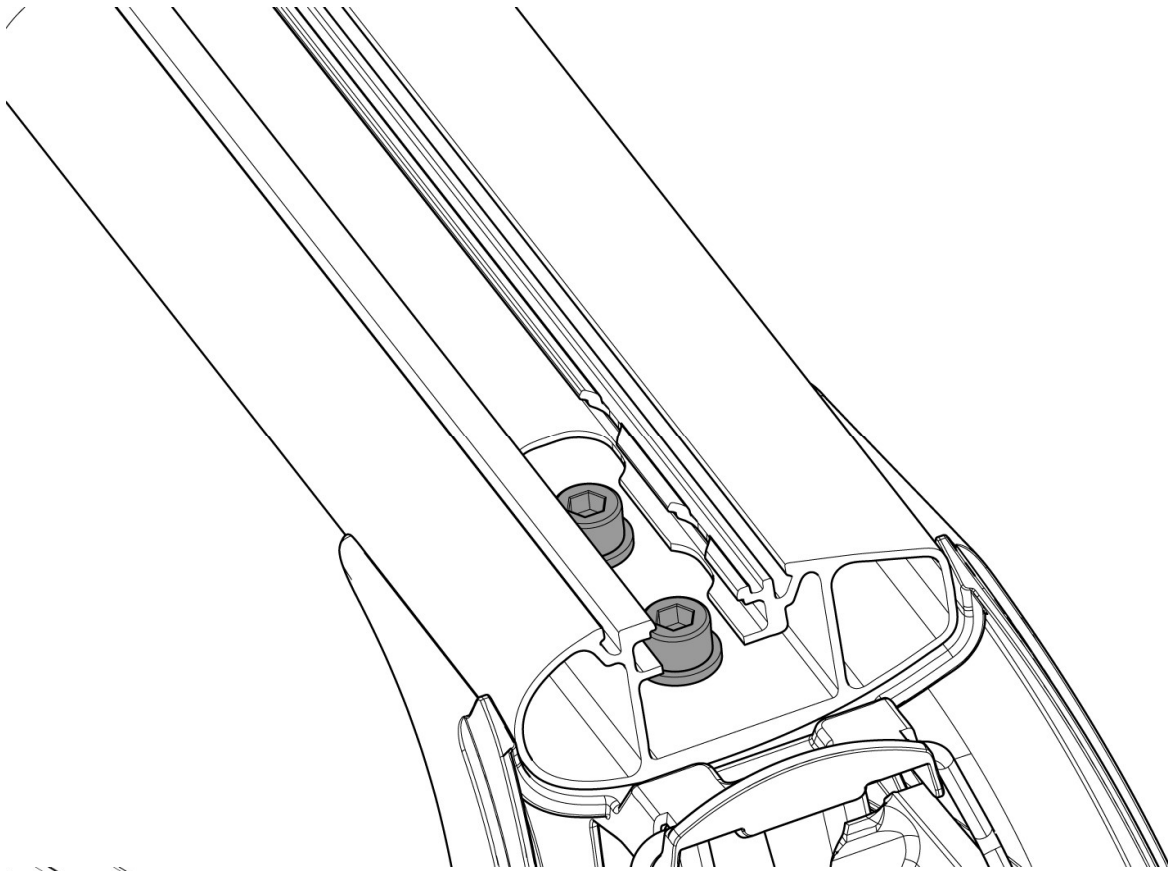

Position the attaching brace down against the roof edge.

Note

Do not damage the painted surfaces.

Pull out the attaching brace so that the pins **1** become free from the edge of the roof. Loosen the screw **2** if necessary.

Slide in the attaching brace so that the pins fit in the rivet nuts on the door frame. Adjust the load carrier's foot laterally if required.

Press the attaching brace into the car and loosely tighten its screw **2** so that the pins **1** do not fall out of the rivet nuts.

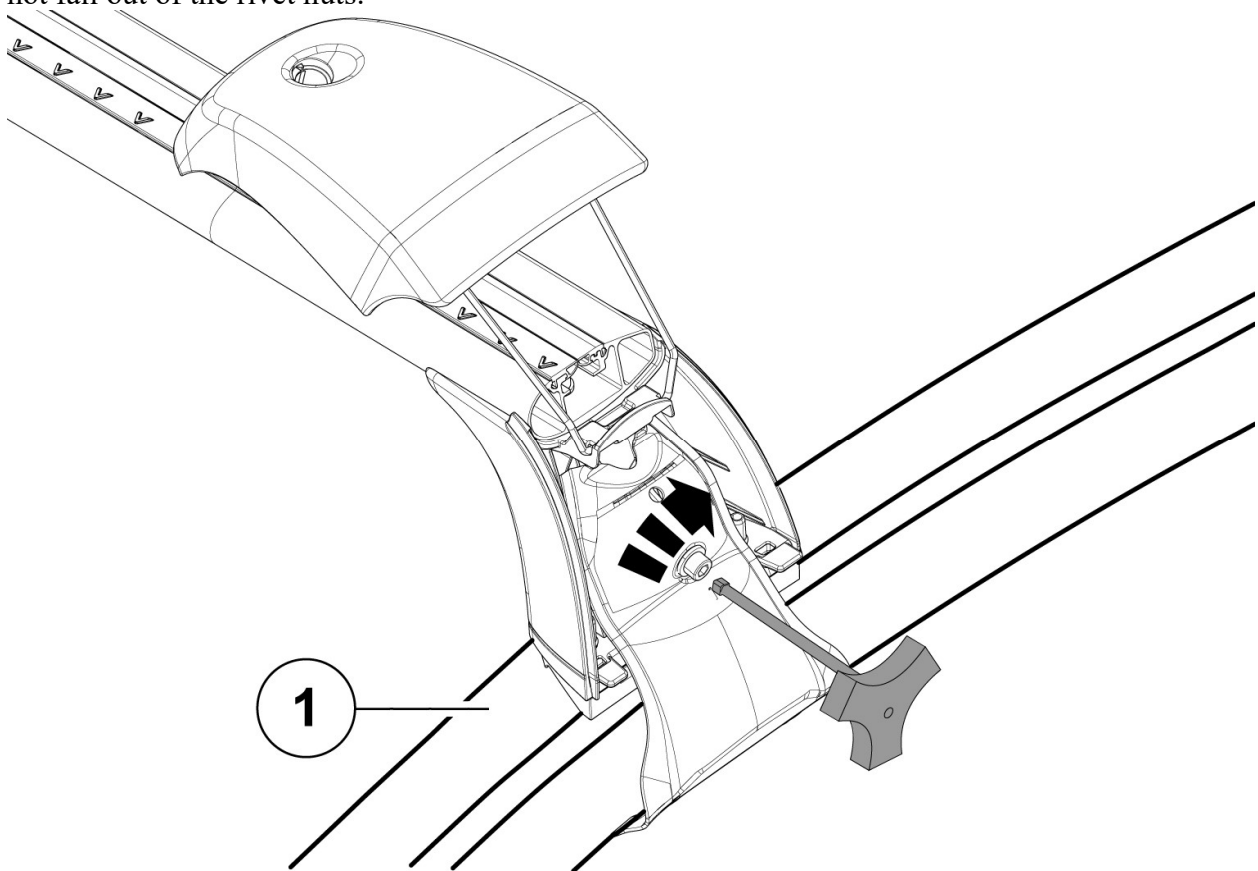

Check that the load carrier's foot **1** is in contact with the edge of the roof.

Tighten the load carrier's screw with the enclosed tool, by tightening alternately on each side. The correct torque has been reached when the tool clicks over.

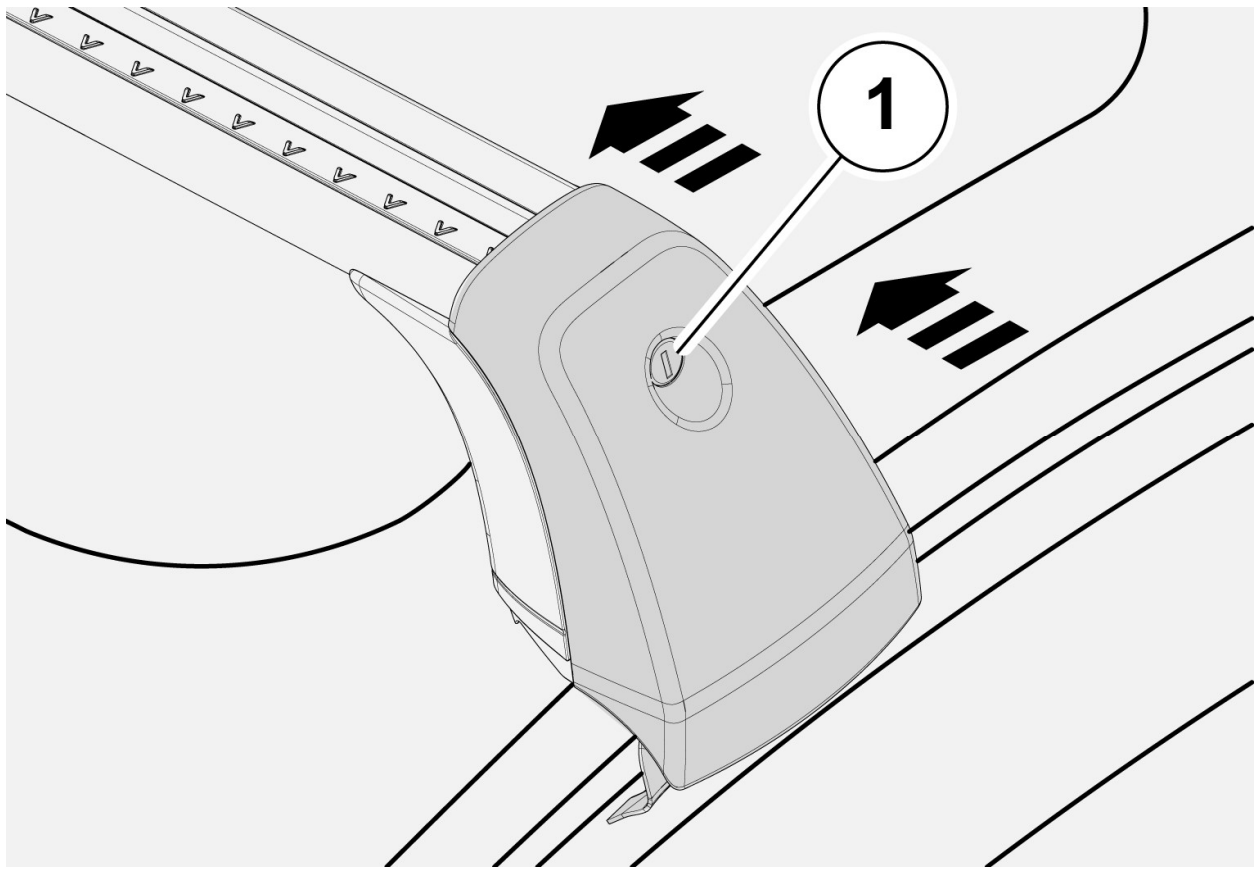

Reinstall the covers on the end faces of the load carriers and turn the locking key 1 90° clockwise.

When using T-groove kit

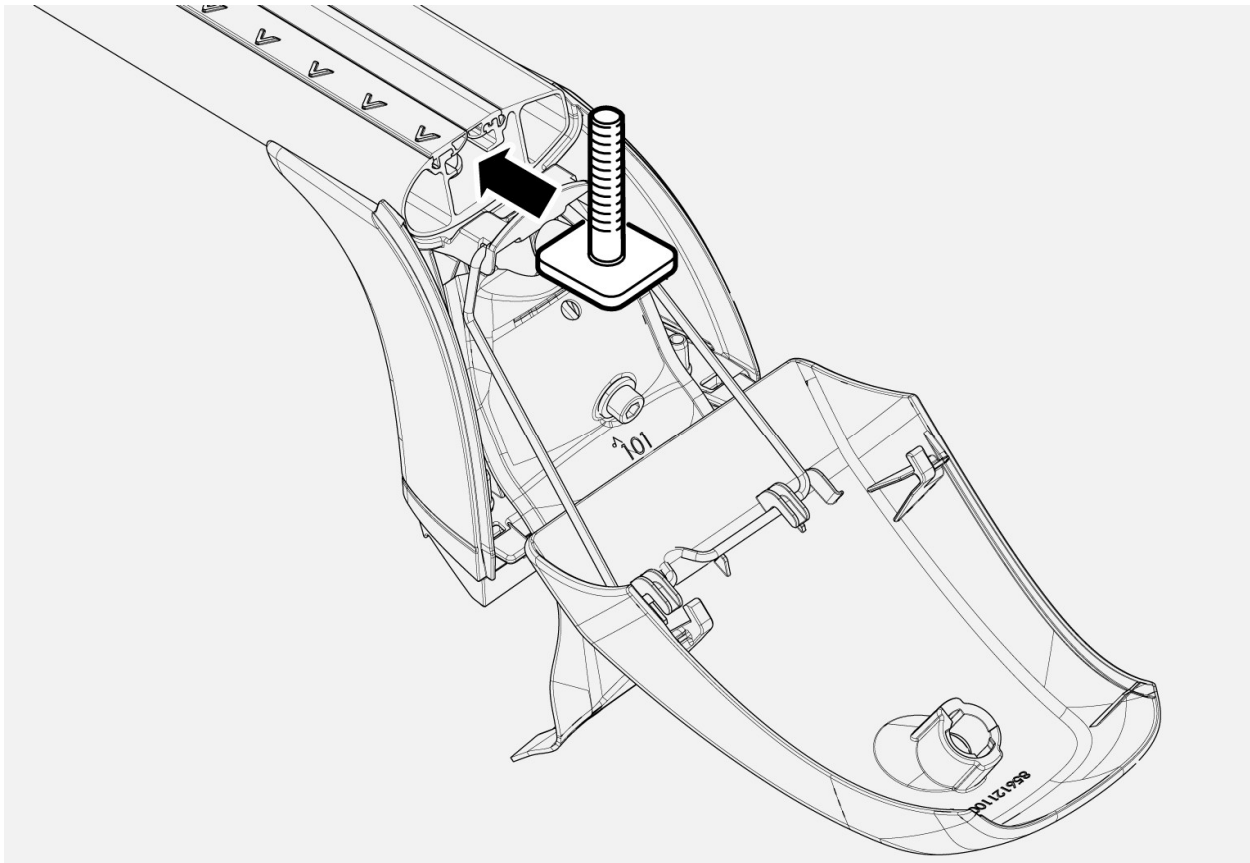

Lower the cover.
Insert the T-track screw in the slot in the trim.

Safety instructions

Note

- Maximum permitted roof load and total weight for the car must not be exceeded (see the owner's manual for the car). Maximum roof load consists of the total of the load carriers' unladen weight, accessories and load.
- Distribute the load evenly over the loading surface, with as low a centre of gravity as possible, and secure it so that it cannot come loose.
- Check the position and securement of the load at regular intervals
- Check bolted joints and brackets after a short driving distance. If necessary, tighten to the prescribed torque. Check at regular intervals.
- The car's driving characteristics and crosswind sensitivity are changed by a load on the roof. Adapt speed according to vehicle load (max. 130 km/h / 80 mph). Always follow applicable speed limits and other traffic laws.
- For the safety of other road users and to save energy, remove the load carriers when not in use.